

# SOLENOID VALVES | Special Purpose

## High pressure

### GEM-HP | 1/4" - 1" 2 Way NC, NO



Brass | 1/2"



Stainless Steel | 1/2"

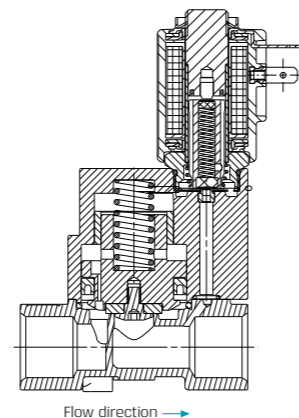

#### Technical Data

Function	2 Way NC, NO
Ports size	1/4", 3/8", 1/2", 3/4", 1" BSP & NPT
Pressure range	See table
Kv (l/min)	See table
Temperature range	<b>Fluid :</b> -10°C to 80°C (no freezing) <b>Ambient :</b> -10°C to 50°C
Materials in contact with media	<b>Main Valve:</b> Brass, Stainless Steel AISI 316 <b>Solenoid Operator:</b> Stainless Steel AISI 300 & 400 series <b>Seals:</b> Polyurethane, FPM (Viton®)*, EPDM*, PTFE * The orifice seal is PTFE
Coil voltage	• Voltage and power consumption - see table • All Baccara coil voltages are ± 10% of nominal
Standard protection class	IP65 with connector * Option : IP68 (please refer to GEM-BP Coil)

• Latch valves are available upon request.

#### Pressure (bar) & Flow table NC

Size	Orifice (mm)	Pressure (bar)	Kv(l/min)
1/4"	8	1 to 60	12
3/8"	8		16
1/2"	12		35
3/4"	20		130
1"	25		200

#### Pressure (bar) & Flow table NO

Size	Orifice (mm)	Pressure (bar)	Kv(l/min)
1/4"	8	1 to 30	12
3/8"	8		16
1/2"	12		35
3/4"	20		130
1"	25		200

#### Voltage & Power Consumption

V	AC (W)						DC (W)		
	50 Hz			60 Hz			10	5.5	3.5
	8	5.5	2.5	8	5.5	2.5			
6							•		
12	•			•			•		
24	•			•			•		
48	•			•			•		
110	•			•			•		
120	•			•			•		
220	•			•			•		
230	•			•			•		
240	•			•			•		

• Available options

## High pressure | GEM-SOL | 1/4" - 1" 2 Way NC, NO

#### Dimensions

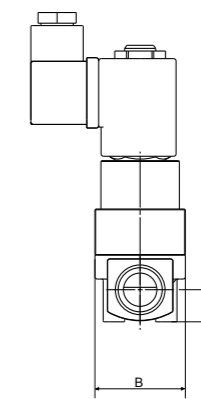
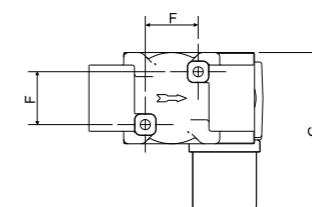

Size	A	B	C	D	E	F	G
1/4"-3/8"	58	32	10.5	118	91.5	22	58.9
1/2"	69	38	13	130	102.5	22	64.9
3/4"	90	55	17	140	-	-	73.1
1"	100	65	21	151	-	-	78.1

#### How to Order

GEM-HP	-	BODY	PORT	FUNCTION	SEALS	-	* When ordering without coil, please define what current and pressure rating is needed (DC, AC)		CONNECTOR					
							VOLTAGE	POWER						
		Brass	2	1/4" BSP	20	2W NC	1	Polyurethane P	W/out coil	0	No coil	0	without	0
		Stainless Steel	3	1/4" NPT	21	2W NO	2	FPM <sup>(1)</sup> (Viton®)	6	1	ACBW 50Hz	1	with	1
				3/8" BSP	30			EPDM <sup>(1)</sup>	12	2	ACBW 60Hz	2	with LED	2
				3/8" NPT	31			PTFE	24	3	DC10W	3	with bi-color LED	3
				1/2" BSP	40				48	4			flying leads coil	4
				1/2" NPT	41				110	5			with 1/2" Hub	5
				3/4" BSP	50				120	6			surge protection with LED	6
				3/4" NPT	51				220	7A			connector with moulded cable	7
		1" BSP	60		230	7			other	9				
		1" NPT	61		240	8								
					Latch/other <sup>(2)</sup>	9								

Example : GEM-HP-2201P-321

GEM-SOL high pressure pilot operated, brass, 1/4"BSP, 2W NC, polyurethane seals, 24V AC 8W 60Hz with connector.

GEM-HP - 2 20 1 P - 3 2 1

(1) The orifice seal is PTFE

(2) For specifying Latch type coil, please refer to GEM-A3P valve - How to Order table.

\* To order valves manufactured according to your specific requirements, please contact our technical sales department.